

PC board drilling dimensions(after plating)

(thickness ≤ 3.20±0.30mm)

Pitch 2.76(shell 25-37)

Pitch 2.74(shell 09-15)

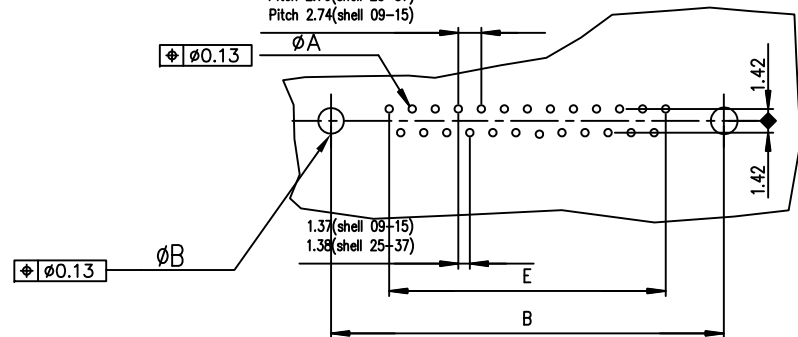

ROHS PART NUMBER

SHELL	A±0.38	B±0.12	C±0.10	D±0.25	E±0.07	200 Mating	500 Mating
09	30.81	24.99	16.96	16.79	10.96	D09P91C4GX00LF	D09P91C6GX00LF
15	39.14	33.32	25.18	25.12	19.18	D15P91C4GX00LF	D15P91C6GX00LF
25	53.03	47.04	39.12	38.84	33.12	D25P91C4GX00LF	D25P91C6GX00LF
37	69.32	63.50	55.68	55.30	49.68	D37P91C4GX00LF	D37P91C6GX00LF

GENERAL CHARACTERISTICS AND ROHS INFORMATIONS:
SEE DRAWING C01-8646-0001

mat'l. code		surface ISO 1302 ✓		tolerance ISO 406 ISO 1101		projection		product family D-SUB	
ltr	ecn no	dr	date	tolerances unless otherwise specified		mm		title	
H	ELX-I-21654	AB	2015-10-26	angles	linear	.0±0.1	scale 2:1	MALE DELTA-D STRAIGHT PRESS-FIT	
J	ELX-I-24020	AAB	2016-06-06	0'±2'		.00±0.1			
		dr	PESSON	1994-10-20			dwg no		sheet 1 of 1
		engr	MITHUN PAUL	2016-06-06			C01-8646-0323		A3
		chr	ATHUL A.B	2016-06-06			type		Product Customer Drawing
		appd	BIJU K PAUL	2016-06-06					
sheet index	revision	J							
	sheet	1							