

THIS DRAWING IS UNPUBLISHED. RELEASED FOR PUBLICATION  
 © COPYRIGHT BY TYCO ELECTRONICS CORPORATION. ALL RIGHTS RESERVED.

LOC		DIST		REVISIONS			
P	LTR	DESCRIPTION		DATE	DWN	APVD	
	F2	REVISED PER ECO-07-005135		07MAR07	KW	DB	

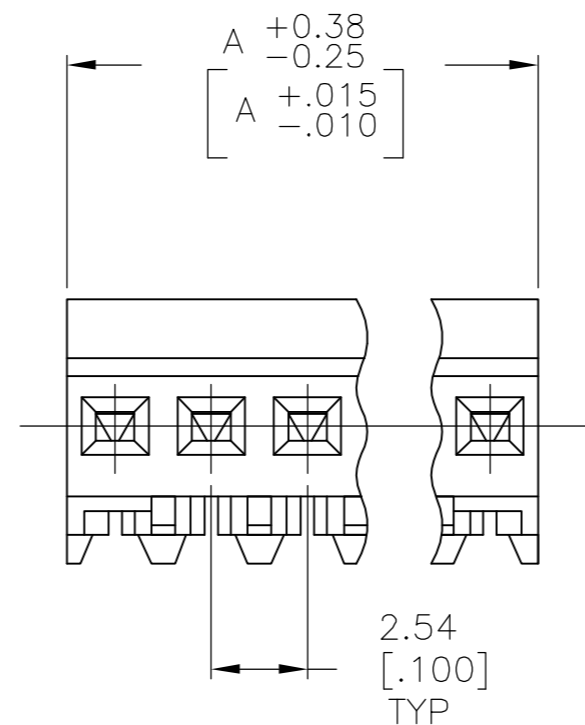
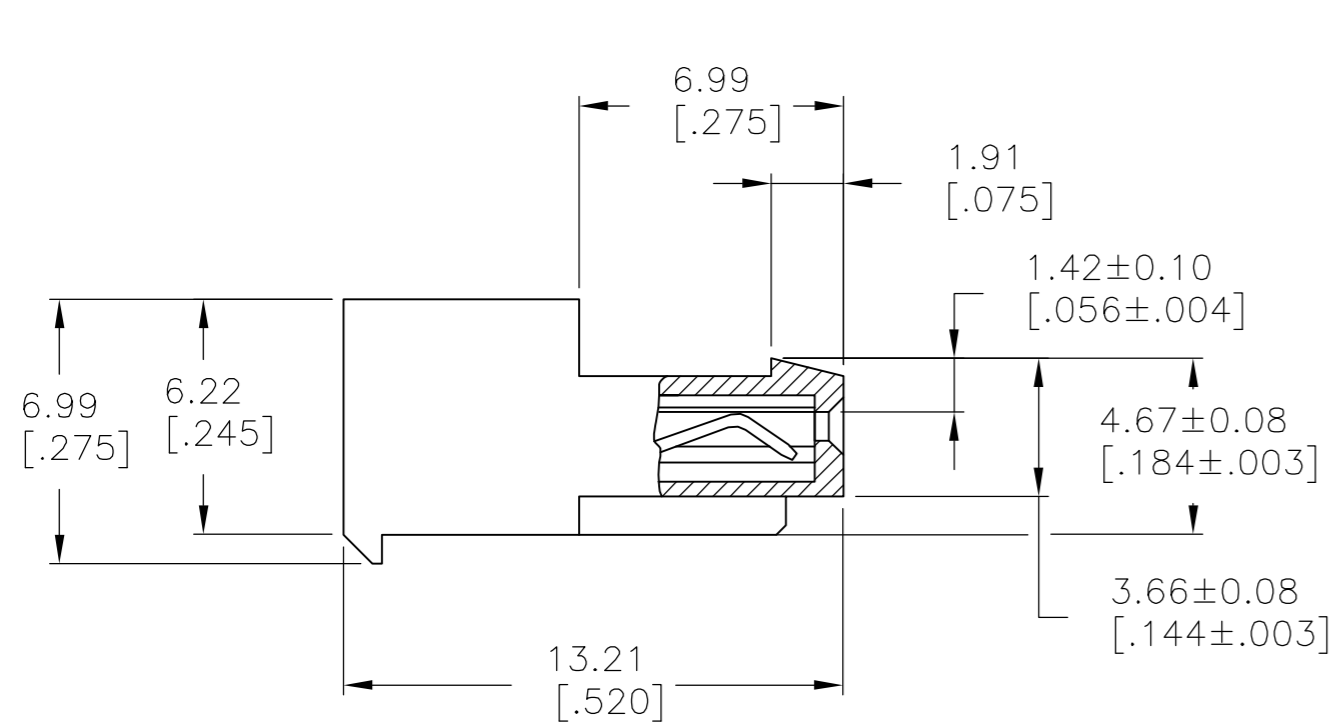
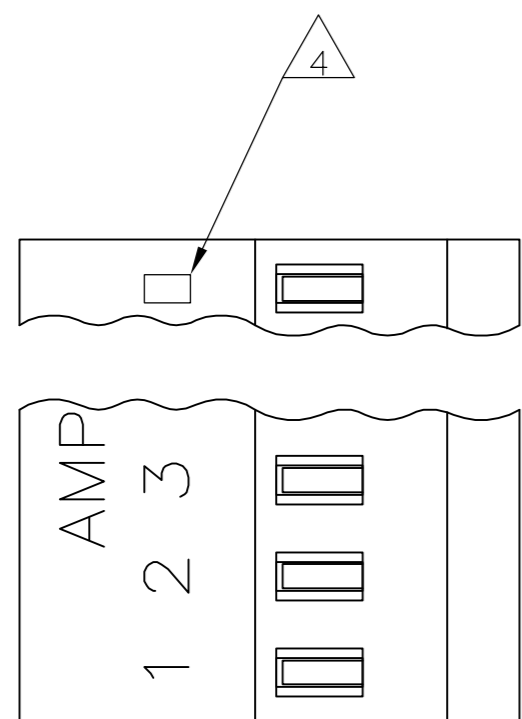

- 1. MATERIAL: CONNECTOR - NYLON UL94V-2 (RED).  
CONTACTS - 0.30[.012] THICK COPPER ALLOY (0.00038 [.000015] GOLD) OVER (0.00203 [.000080] MIN THICK BRIGHT TIN-LEAD (93/7) FOR -9 OR MATTE FOR -39
- 2. CONTACTS ACCEPT 22 AWG WIRE WITH 1.52[.060] MAX INSULATION DIAMETER.
- 3. CONTACTS MUST ACCEPT 0.36-0.51[.014-.020] SQUARE OR ROUND POST AND REMAIN LOCKED IN POSITION.
- 4. IDENTIFICATION NUMBER FOR LAST CIRCUIT MAY NOT APPEAR ON ALL ASSEMBLIES.
- 5. DIMENSIONS IN BRACKETS ARE IN INCHES.
- 6. HOUSING FEATURES ARE: CLOSED END WITH LOCKING RAMP & LED CONTACT.

DIM A	NO OF CKTS	PART NO
22.86 [.900]	9	3-644151-9
22.86 [.900]	9	644151-9

**METRIC**

THIS DRAWING IS A CONTROLLED DOCUMENT.		DWN K. WHITAKER 23JUN05	Tyco Electronics Corporation Harrisburg, PA 17105-3608	
DIMENSIONS: mm [INCHES]		CHK D. BOSSI 23JUN05	NAME D. BOSSI	
TOLERANCES UNLESS OTHERWISE SPECIFIED:		APVD D. BOSSI 23JUN05	PRODUCT SPEC 108-1050	
0 PLC ± -		APPLICATION SPEC 114-1019		
1 PLC ± -		SIZE A2		
2 PLC ± -		CAGE CODE 00779		
3 PLC ± 0.13[.005]		DRAWING NO C=644151		
4 PLC ± -		RESTRICTED TO -		
ANGLES ± -		SCALE 5:1		
FINISH		SHEET 1 of 1		
MATERIAL		REV F2		
CUSTOMER DRAWING				