

## PCB terminal block - PLA 5/ 2-7,5-ZF MC RD/BK - 1847601

Please be informed that the data shown in this PDF Document is generated from our Online Catalog. Please find the complete data in the user's documentation. Our General Terms of Use for Downloads are valid (<http://phoenixcontact.com/download>)



PCB terminal block, Nominal current: 41 A, Nom. voltage: 1000 V, Pitch: 7.5 mm, Connection method: Push-lock spring connection, Mounting: Wave soldering, Conductor/PCB connection direction: 30 °, Color: multi-color

The figure shows the standard item



### Key Commercial Data

Packing unit	1 STK
Minimum order quantity	50 STK
Weight per Piece (excluding packing)	9.600 g
Custom tariff number	85369010
Country of origin	Slovakia

### Technical data

#### Environmental Product Compliance

China RoHS	No hazardous substances above threshold values
------------	--

#### Dimensions

Pitch	7.50 mm
Dimension a	7.5 mm
Length of the solder pin	3.6 mm
Pin dimensions	1,2 x 1,5 mm
Pin spacing	12.5 mm
Hole diameter	2 mm

#### General

Range of articles	PLA 5/
Rated surge voltage (III/3)	8 kV

# PCB terminal block - PLA 5/ 2-7,5-ZF MC RD/BK - 1847601

## Technical data

### General

Rated surge voltage (III/2)	8 kV
Rated surge voltage (II/2)	8 kV
Rated voltage (III/3)	1000 V
Rated voltage (III/2)	1000 V
Rated voltage (II/2)	1000 V
Nominal current $I_N$	41 A
Nominal cross section	6 mm <sup>2</sup>
Solder pin surface	Sn
Stripping length	12 mm

### Connection data

Conductor cross section AWG min.	24
Conductor cross section AWG max.	10
2 conductors with same cross section, stranded, TWIN ferrules with plastic sleeve, min.	0.75 mm <sup>2</sup>
2 conductors with same cross section, stranded, TWIN ferrules with plastic sleeve, max.	4 mm <sup>2</sup>

## Drawings

Drilling diagram

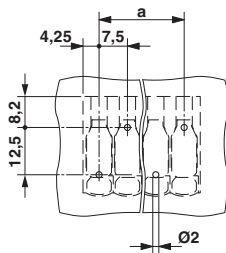

Dimensional drawing

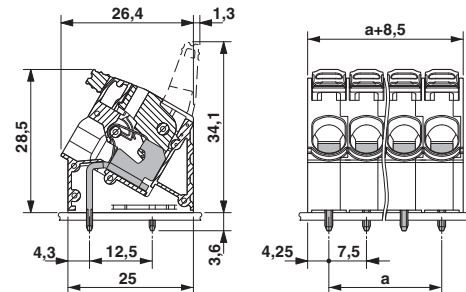

## Classifications

eCl@ss

eCl@ss 5.1	27141190
eCl@ss 6.0	27261101
eCl@ss 8.0	27440401
eCl@ss 9.0	27440401

# PCB terminal block - PLA 5/ 2-7,5-ZF MC RD/BK - 1847601

## Classifications

ETIM

ETIM 5.0	EC002643
----------	----------

## Approvals

Approvals

Approvals

VDE approval of drawings / EAC

Ex Approvals

## Approval details

VDE approval of drawings  <a href="http://www.vde.de">http://www.vde.de</a> 40041250	
mm <sup>2</sup> /AWG/kcmil	0.2-6
Nominal current I <sub>N</sub>	41 A
Nominal voltage U <sub>N</sub>	1000 V

EAC B.01742
-------------