

DRAWING MADE IN THIRD ANGLE PROJECTION

THIS DRAWING IS UNPUBLISHED. RELEASED FOR PUBLICATION, 19 .  
 © COPYRIGHT 19 BY AMP INCORPORATED, HARRISBURG, PA. ALL INTERNATIONAL RIGHTS RESERVED. AMP PRODUCTS MAY BE COVERED BY U.S. AND FOREIGN PATENTS AND/OR PATENTS PENDING.

LOC	DIST	P	F	ZONE	LTR	DESCRIPTION	DATE	APPROVED
AD	39				A	REV PER 0621-0061-98	12-9-97	BS
					B	REV PER 0621-0067-98	18JUL98	MC
					C	REV PER 0621-0265-98	19OCT98	MC

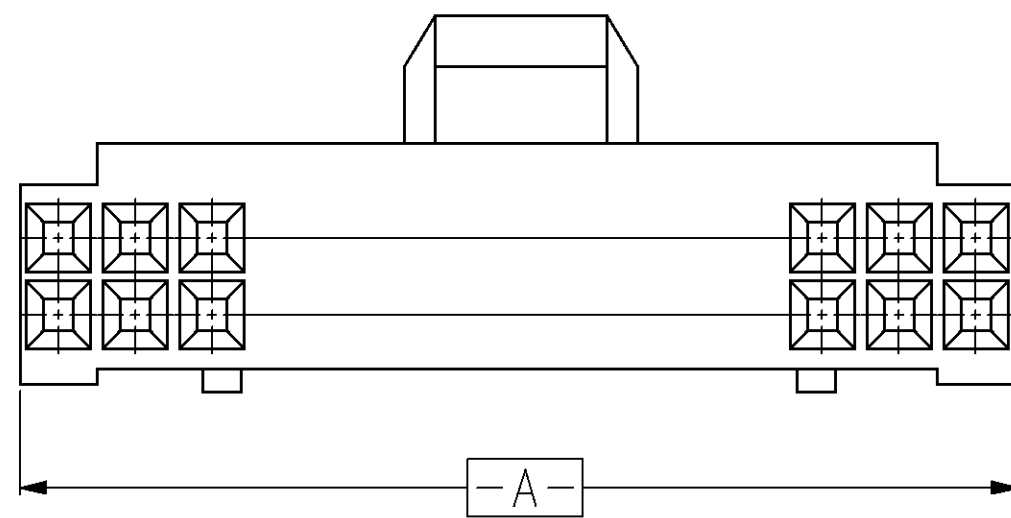
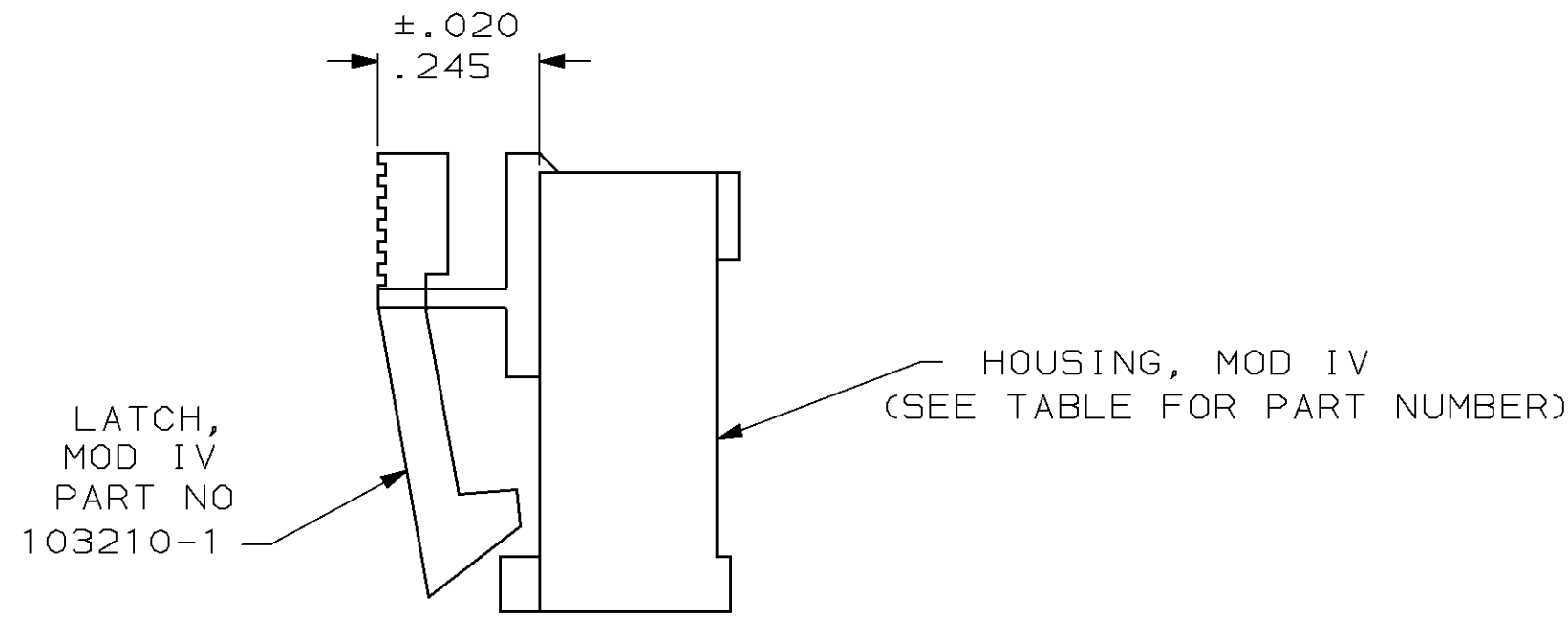
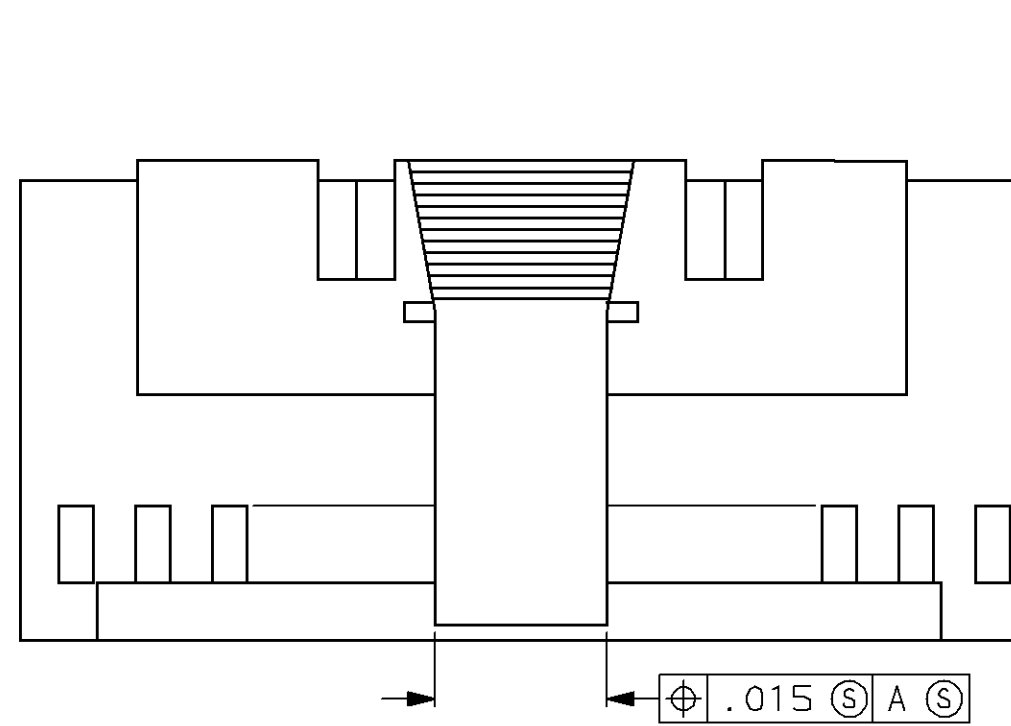

1. LATCH IS ULTRASONICALLY WELDED TO HOUSING

2-87631-9	34	147054-1
HOUSING PART NUMBER	NO OF POSN	ASSEMBLY PART NUMBER

UNLESS OTHERWISE SPECIFIED DIMENSIONS ARE IN INCHES TOLERANCES ON : 2 PL DEC ± - 3 PL DEC ± .005 ANGLES ± -	DR 11-6-97 B.SPINK	AMP INCORPORATED Harrisburg, Pa. 17105	
	CHK 11-6-97 B.SPINK		
MATERIAL: HOUSING & LATCH: FLAME RETARDANT THERMOPLASTIC COLOR: BLACK	APPD -	NAME ASSY, MOD IV, HOUSING & LATCH, DBL ROW, .100 X .100Ø, WITH POLARIZATION AND DETENTS	
	APPD -		
FINISH:	PRODUCT SPEC 108-25020	SIZE C	FSCM NO 00779
	APPLICATION SPEC	DRAWING NO 147054	
	WEIGHT	SCALE 4:1	SHEET 1 OF 1