

SPECIFICATIONS

FITS:
ST1 and ST2 Series with M12x1.0 Bushing

APPROVALS:

RoHS
COMPLIANT

MATERIALS

CAP (1):
Silicone Rubber

BASE (2):
Polyamide 66 (PA66)

NUT (3):
Chrome Plated Brass

COLORS

CAP:
Black

BASE:
Black

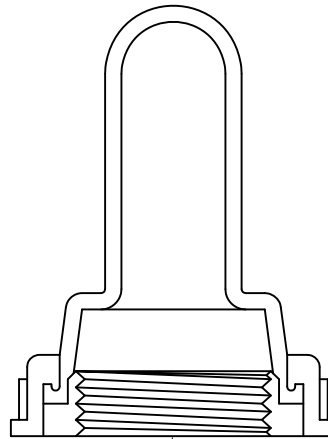
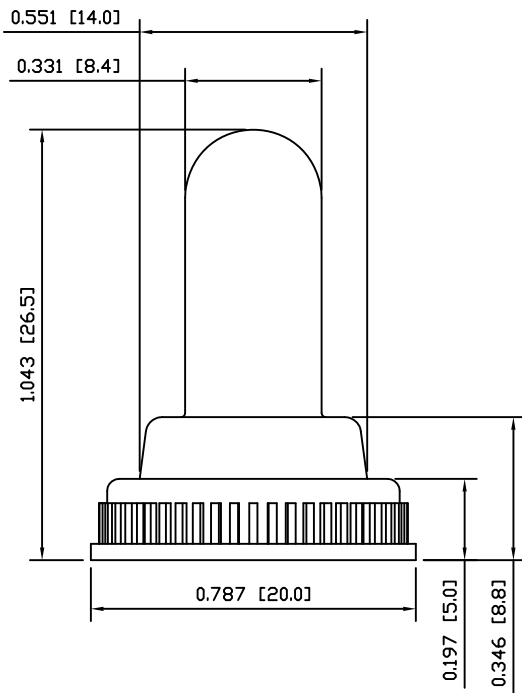
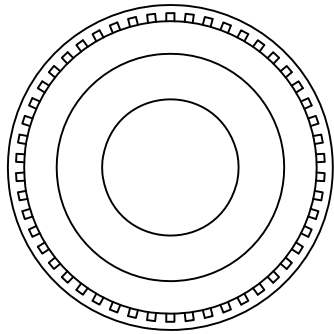

M12x1.0

CUTAWAY VIEW

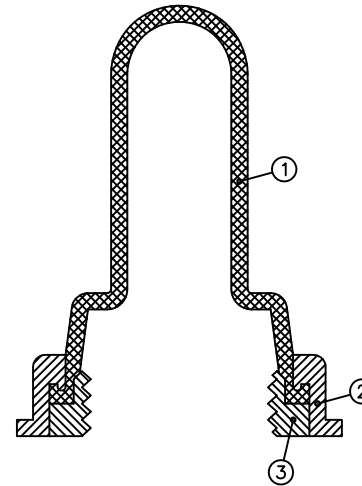

MATERIAL VIEW

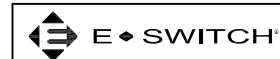

ACC-B03-2

DIMENSIONS	
INCHES [MILLIMETERS]	
GENERAL TOLERANCES	
±0.008 [±0.2] / ±1'	
SCALE	PROJECTION
DRAWING NOT TO SCALE	1st Angle

ITEM NUMBER	DATE	REVISION
34-ACCB032	FEBRUARY 8, 2010	A

THE INFORMATION CONTAINED IN THIS DOCUMENT IS PROPRIETARY TO E-SWITCH AND IS NOT TO BE COPIED OR TRANSFERRED

A	INITIAL RELEASE	18661	10/02/08	CAB
REV.	DESCRIPTION	PCR	DATE	DRAWN BY