

THIS DRAWING IS UNPUBLISHED. RELEASED FOR PUBLICATION
 © COPYRIGHT BY TYCO ELECTRONICS CORPORATION. ALL INTERNATIONAL RIGHTS RESERVED.

LOC	DIST	REVISIONS			
P	LTR	DESCRIPTION	DATE	DWN	APVD
AF	50	A1	REVISED PER ECR-09-001883	02FEB09	HMR KR

- 1 CONTINUOUS STRIP ON REELS WITH TERMINALS LOCATED ON 5.59±0.08 [.220±.003] CENTERS.
- 2 SLOT ACCEPTS A SINGLE 0.36-0.57mm [#27-#23] AWG COPPER MAGNET WIRE.
- 3 AFTER INSERTION INTO PLASTIC HOLDER TAB PORTION MUST BE BENT OVER 45° TO 90° OR POTTED TO PREVENT PULL-OUT WHEN MATING RECEPTACLE IS DISCONNECTED.
- 4 PRELIMINARY - NOT FOR PRODUCTION.

IDENTIFICATION NUMBER 10 FOR MAGNET WIRE RANGE

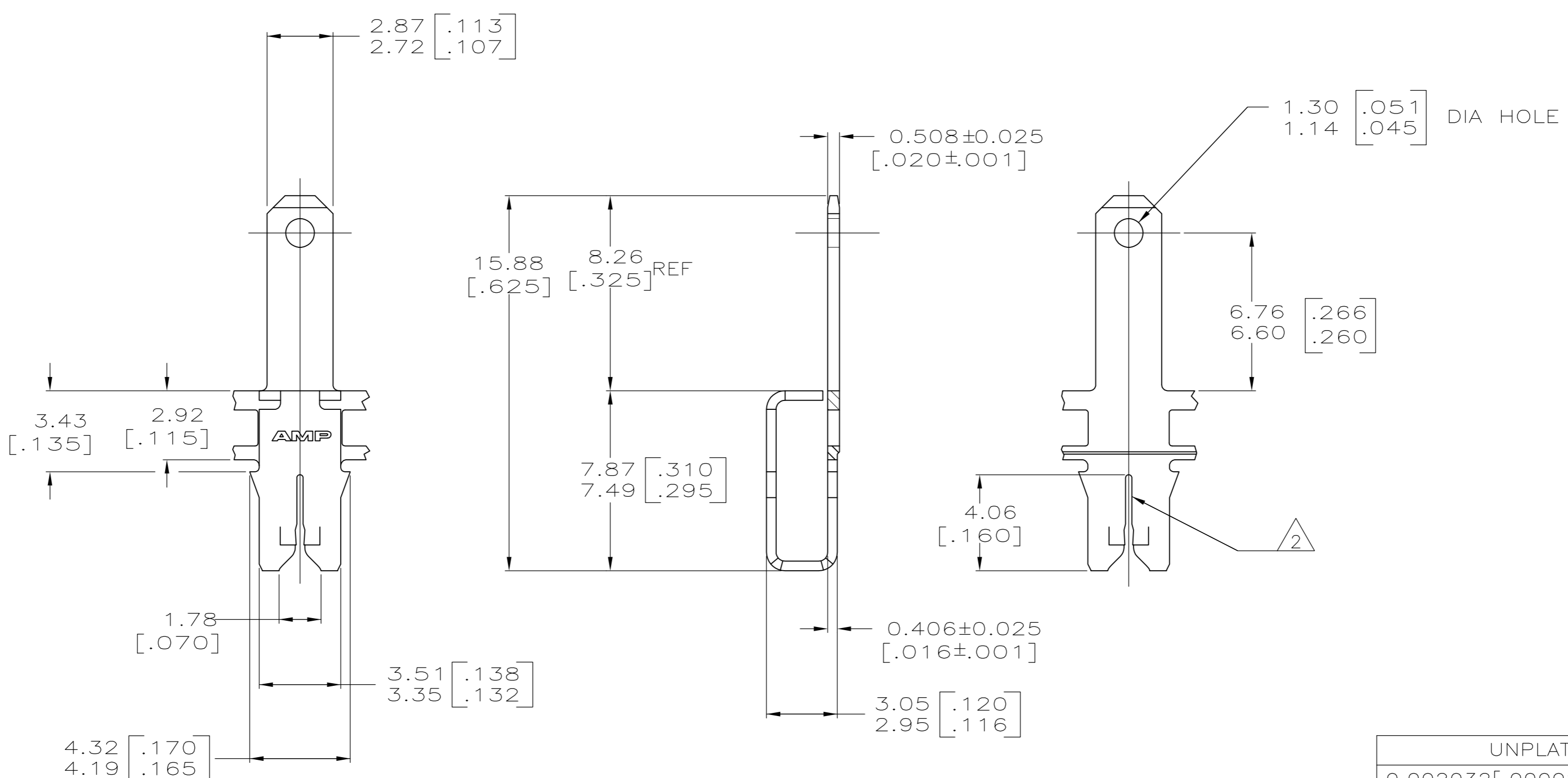
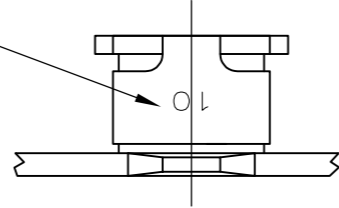

UNPLATED	4 63746-2
0.002032[.000080] MIN TIN	63746-1
FINISH	PART NO

THIS DRAWING IS A CONTROLLED DOCUMENT.		DWN 11/JAN/94 MICHAEL S. FEHER	Tyco Electronics Corporation Harrisburg, PA 17105-3608	
DIMENSIONS: mm [INCHES]		CHK 13/JAN/94 PHILLIP M. FORTNEY	NAME TAB, 2.79 [.110] FASTON™ MAG-MATE™	
TOLERANCES UNLESS OTHERWISE SPECIFIED:		APVD 14/JAN/94 NELSON E. NEFF	PRODUCT SPEC 108-2012	
0 PLC ± -		APPLICATION SPEC 114-2046		
1 PLC ± -		SIZE A2		
2 PLC ± 0.25 [.010]		CAGE CODE 00779		
3 PLC ± -		DRAWING NO C=63746		
4 PLC ± -		RESTRICTED TO -		
ANGLES ± -		SCALE 6:1		
FINISH SEE TABLE		SHEET 1 OF 1		
MATERIAL 4M HARD BRASS		REV A1		
CUSTOMER DRAWING		SCALE 6:1		