

## Feed-through header - MCV 0,5/ 4-G-2,5 THT - 1963557

Please be informed that the data shown in this PDF Document is generated from our Online Catalog. Please find the complete data in the user's documentation. Our General Terms of Use for Downloads are valid (<http://phoenixcontact.com/download>)



PCB headers, nominal current: 4 A, rated voltage (III/2): 160 V, number of positions: 4, pitch: 2.5 mm, color: black, contact surface: Tin, mounting: THR soldering, User information and design recommendations for through hole reflow technology can be found under "Downloads"

The figure shows a 10-position version of the product

### Why buy this product

- Designed for integration into the SMT soldering process
- Vertical connection enables multi-row arrangement on the PCB

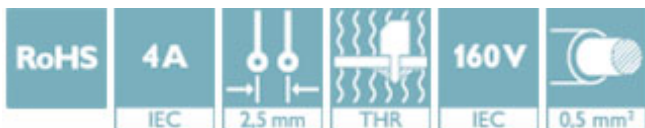

### Key Commercial Data

|              |   |
|--------------|---|
| Packing unit | 50 STK  |
| GTIN         | <br>4 017918 912369 |
| GTIN         | 4017918912369   |

### Technical data

#### Dimensions

|                          |              |
|--------------------------|--------------|
| Length [ l ]             | 8.1 mm       |
| Width                    | 11.9 mm      |
| Pitch                    | 2.5 mm       |
| Dimension a              | 7.5 mm       |
| Width [ w ]              | 11.9 mm      |
| Height [ h ]             | 10.1 mm      |
| Constructional height    | 10.1 mm      |
| Length of the solder pin | 3.5 mm       |
| Pin dimensions           | 0.8 x 0.8 mm |
| Pin spacing              | 2.50 mm      |
| Length                   | 8.1 mm       |

#### General

# Feed-through header - MCV 0,5/ 4-G-2,5 THT - 1963557

## Technical data

### General

|  |                   |
|--|-------------------|
| Range of articles                      | MCV 0,5/...-G-THT |
| Insulating material group              | IIIa              |
| Rated surge voltage (III/3)            | 1.5 kV            |
| Rated surge voltage (III/2)            | 2.5 kV            |
| Rated surge voltage (II/2)             | 2.5 kV            |
| Rated voltage (III/3)                  | 32 V              |
| Rated voltage (III/2)                  | 160 V             |
| Rated voltage (II/2)                   | 160 V             |
| Connection in acc. with standard       | EN-VDE            |
| Nominal current $I_N$                  | 4 A               |
| Maximum load current                   | 4 A               |
| Insulating material                    | PA                |
| Flammability rating according to UL 94 | V0                |
| Color                                  | black             |
| Number of positions                    | 4                 |

### Standards and Regulations

|  |        |
|--|--------|
| Connection in acc. with standard       | EN-VDE |
|  | CUL    |
| Flammability rating according to UL 94 | V0     |

### Environmental Product Compliance

|            |   |
|------------|---|
| China RoHS | Environmentally friendly use period: unlimited = EFUP-e |
|            | No hazardous substances above threshold values          |

## Drawings

Dimensional drawing

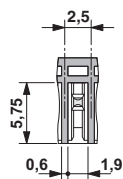

Drilling diagram

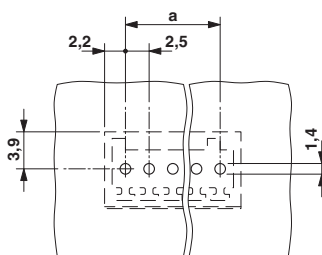

# Feed-through header - MCV 0,5/ 4-G-2,5 THT - 1963557

Dimensional drawing

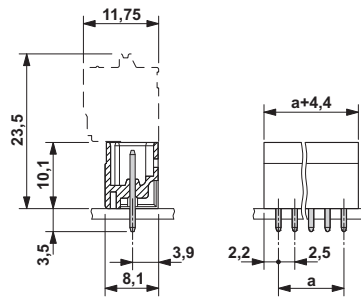

## Approvals

### Approvals

#### Approvals

VDE Gutachten mit Fertigungsüberwachung / IECEE CB Scheme / CCA / EAC / cULus Recognized

#### Ex Approvals

### Approval details

|   |      |   |          |
|---|------|---|----------|
| VDE Gutachten mit Fertigungsüberwachung |      | <a href="http://www2.vde.com/de/Institut/Online-Service/VDE-gepruefteProdukte/Seiten/Online-Suche.aspx">http://www2.vde.com/de/Institut/Online-Service/VDE-gepruefteProdukte/Seiten/Online-Suche.aspx</a> | 40013394 |
| Nominal voltage UN                      | 32 V |   |          |
| Nominal current IN                      | 4 A  |   |          |

|                    |      |   |                |
|--------------------|------|---|----------------|
| IECEE CB Scheme    |      | <a href="http://www.iecee.org/">http://www.iecee.org/</a> | DE1-56068-B1B2 |
| Nominal voltage UN | 32 V |   |                |
| Nominal current IN | 4 A  |   |                |

|                    |                |  |  |
|--------------------|----------------|--|--|
| CCA                | CCA/ DE1 34250 |  |  |
| Nominal voltage UN | 32 V           |  |  |
| Nominal current IN | 4 A            |  |  |

# Feed-through header - MCV 0,5/ 4-G-2,5 THT - 1963557

## Approvals

|     |   |         |
|-----|---|---------|
| EAC |  | B.01742 |
|-----|---|---------|

|                    |   |   |                 |
|--------------------|---|---|-----------------|
| cULus Recognized   |  | <a href="http://database.ul.com/cgi-bin/XYV/template/LISEXT/1FRAME/index.htm">http://database.ul.com/cgi-bin/XYV/template/LISEXT/1FRAME/index.htm</a> | E60425-19930913 |
|                    |   | B   |                 |
| Nominal voltage UN |   | 125 V   |                 |
| Nominal current IN |   | 4 A   |                 |

Phoenix Contact 2018 © - all rights reserved  
<http://www.phoenixcontact.com>

PHOENIX CONTACT GmbH & Co. KG  
Flachsmarktstr. 8  
32825 Blomberg  
Germany  
Tel. +49 5235 300  
Fax +49 5235 3 41200  
<http://www.phoenixcontact.com>