

Tous droits strictement reserves. Reproduction ou communication a des tiers interdite sous quelque forme que ce soit sans autorisation écrite du propriétaire. Propriete de c FCI. Droits de reproduction FCI.

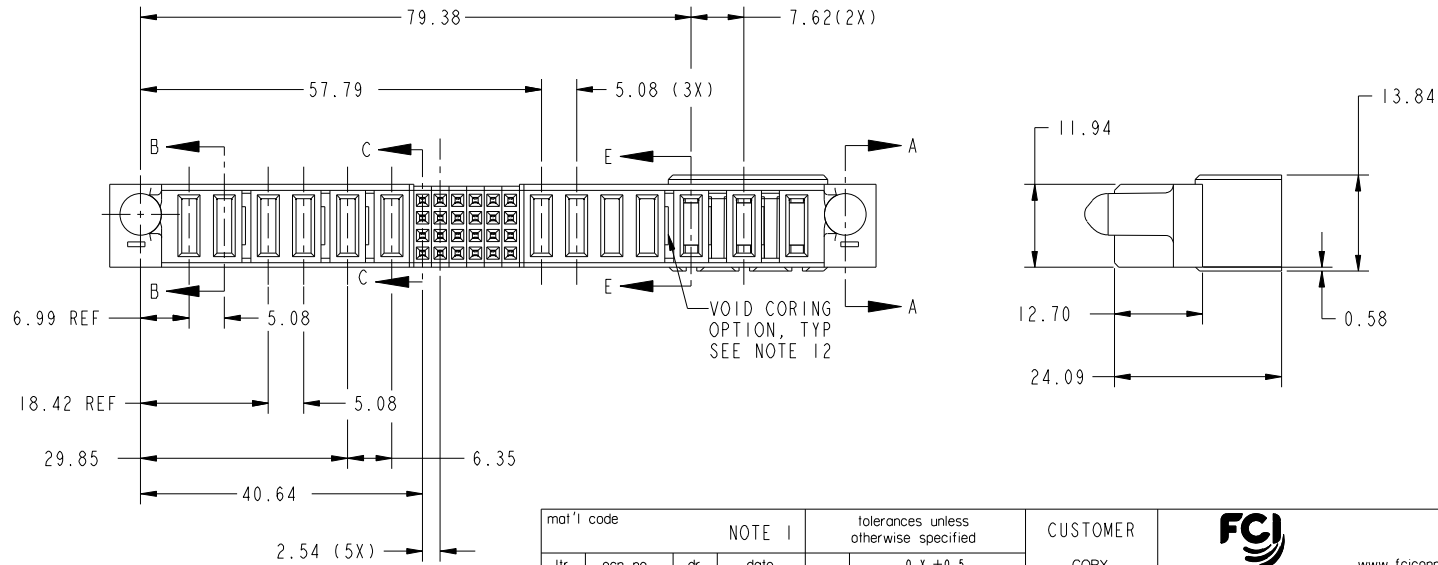

All rights strictly reserved. Reproduction or issue to third parties in any form whatever is not permitted without written authority from the proprietor. Property of FCI. Copyright FCI.

PRODUCT NUMBER
51955-002H

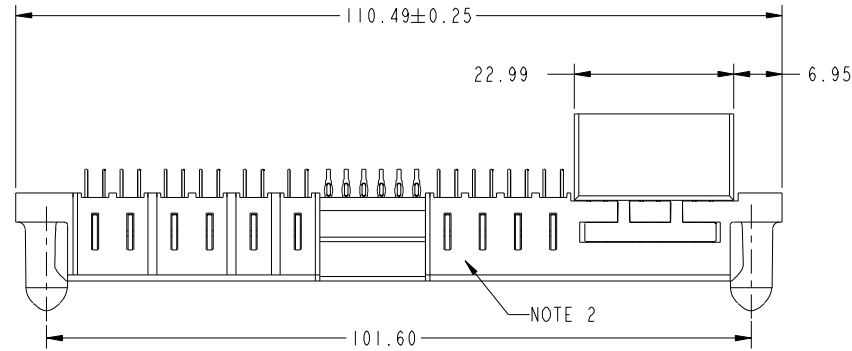

mat'l code				NOTE 1		tolerances unless otherwise specified		CUSTOMER		FCI	
ltr	ecn no.	dr	date	linear	0.X ± 0.5	COPY		projection		www.fciconnect.com	
A	DG07-0093	JMG	03/20/07		0.XX ± 0.25	MIM		title		3ACP + 4P + 24S + 6P	
B	DG07-0112	JMG	03/29/07		0.XXX ± 0.10	scale		product family		PwrBlade code	
C	DG07-0498	JW	08/12/08	angles	0° ± 2°	1:1		size		213	
				dr	JM GUO 03/20/07			dwg no		1 of 4	
				enr	RYAN YUAN 03/20/07			51955-002			
				chr	GARY HSIEH 03/20/07			cage code		22526	
				appd	JOSEPH HSIA 03/20/07						
sheet index	revision sheet	C 1	C 2	C 3	C 4						

Pro/E

cage code 22526

Tous droits strictement reserves. Reproduction ou communication a des tiers interdite sous quelque forme que ce soit sans autorisation écrite du propriétaire. Propriete de c FCI. Droits de reproduction FCI.



All rights strictly reserved. Reproduction or issue to third parties in any form whatever is not permitted without written authority from the proprietor. Property of FCI. Copyright FCI.

PRODUCT No.	ROWS	E2	P13	P12	P11	P10	P9	P8	6	5	4	3	2	1	P7	P6	P5	P4	P3	P2	P1	E1
51955-002H	D C B A		PF	PF	PF	PF	PF	PF	F	F	F	F	F	F	PF	PF	PF	PF	PG	PH	PH	

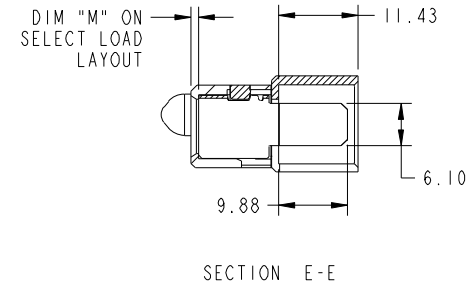
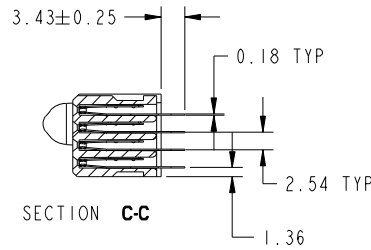
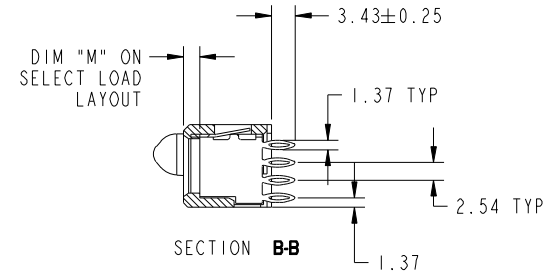
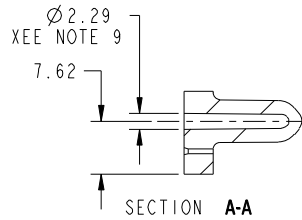

CODE	DIM "M"	CONTACT TYPE
F	[N/A]	SIGNAL
PF	[2.34]	POWER
PG	[1.07]	POWER
PH	[2.34]	POWER

mat'l code		NOTE 1		tolerances unless otherwise specified		CUSTOMER		www.fciconnect.com	
ltr	ecn no.	dr	date	linear	0.X ± 0.5	COPY		title	
C				angles	0.XX ± 0.25	projection		3ACP + 4P + 24S + 6P	
				dr	0.XXX ± 0.10			VERTICAL P/F RECEPT SPECIAL CABLE	
				enr	0° ± 2°			product family PwrBlade code	
				chr	JM GUO 03/20/07	scale		size	
				appd	RYAN YUAN 03/20/07	1:1		dwg no	
					GARY HSIEH 03/20/07			A 51955-002	
					JOSEPH HSIA 03/20/07			sheet	
sheet index	revision sheet							2	

cage code 22526

Pro/E

Tous droits strictement reserves. Reproduction ou communication a des tiers interdite sous quelque forme que ce soit sans autorisation écrite du propriétaire. Propriete de c FCI. Droits de reproduction FCI.



All rights strictly reserved. Reproduction or issue to third parties in any form whatever is not permitted without written authority from the proprietor. Property of FCI. Copyright FCI.

PRODUCT NUMBER
51955-002H

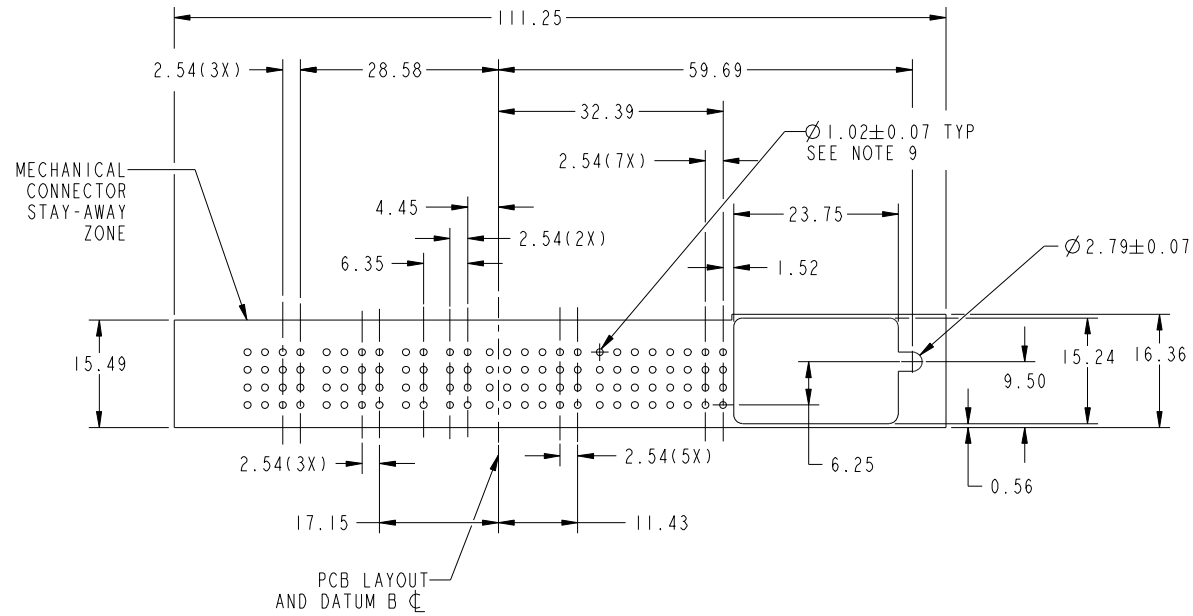

RECOMMENDED PCB LAYOUT

mat'l code		NOTE 1		tolerances unless otherwise specified		CUSTOMER		www.fciconnect.com	
ltr	ecn no.	dr	date	linear	0.X ±0.5	COPY		title	
C					0.XX ±0.25	projection		3ACP + 4P + 24S + 6P	
				angles	0.XXX ±0.10			VERTICAL P/F RECEPT SPECIAL CABLE	
				dr	0° ±2°			product family PwrBlade code	
				enr	JM GUO 03/20/07	scale		size dwg no	
				chr	RYAN YUAN 03/20/07	1:1		A 51955-002	
				appd	GARY HSIEH 03/20/07			sheet	
					JOSEPH HSIA 03/20/07			3	
sheet index	revision sheet								

cage code 22526

Pro/E

Tous droits strictement reserves. Reproduction ou communication a des tiers interdite sous quelque forme que ce soit sans autorisation écrite du propriétaire. Propriete de c FCI. Droits de reproduction FCI.



All rights strictly reserved. Reproduction or issue to third parties in any form whatever is not permitted without written authority from the proprietor. Property of FCI. Copyright FCI.

A

B

PRODUCT NUMBER
51955-002H

CONNECTOR NOTES:

- HOUSING MATERIAL: UL 94 V-0 GLASS FILLED HIGH TEMP THERMOPLASTIC
POWER CONTACT MATERIAL: COPPER ALLOY
SIGNAL CONTACT MATERIAL: COPPER ALLOY
- "MANUFACTURER" NAME, P/N, AND DATE CODE TO APPEAR ON THIS SURFACE
- PLATING:
△ SEE ITEM 7 & 8 IN PRINT 10064183 FOR PLATING SPEC OF 51955-002H RESPECTIVELY.

PCB NOTES:

- ALL DIMENSIONS ARE BASIC UNLESS OTHERWISE SPECIFIED.
- ALL THROUGH HOLES ARE LOCATED WITH A TRUE POSITION OF 0.10
- ALL HOLE DIAMETERS ARE FINISHED HOLE SIZE
- ∅3.20 THROUGH HOLES ARE UNPLATED.
- ∅1.151±0.025 DRILLED HOLES PLATED WITH)
0.008 MIN SnPb OR Sn OVER 0.03
TO 0.08 Cu PLATING TO ACHIEVE
∅1.02±.07 HOLE.
- RECOMMENDED RETENTION TO PCB
∅2.79 THRU HOLE FOR M2.5 SOCKET HEAD CAP SCREW
MAX. HEAD ∅4.5 RECOMMENDED SCREW LENGTH 12 + PCB THICKNESS.
RECOMMENDED SCREW SEATING TO PCB TORQUE: 2-5 lbf-in (2300-5760 gf-cm).
- △SYMBOL WILL BE NEXT TO ANY DIMENSION, VIEW, OR NOTE WHICH HAS BEEN MODIFIED WITH THE CURRENT DRAWING REVISION.
- THE VOID CORING IN BETWEEN POWER MODULES, SIGNAL MODULES AND END MODULES ARE OPTIONAL AND THE SHAPE MAY BE DIFFERENT FOR OPTIMIZING THE MOLDING PROCESS. THE VOID CORING WILL NOT EFFECT TO PRODUCT FUNCTION.

1 | 2

3 |

4

A

B

mat'l code		NOTE 1		tolerances unless otherwise specified		CUSTOMER		www.fciconnect.com				
ltr	ecn no.	dr	date	linear	0.X ±0.5		COPY			title 3ACP + 4P + 24S + 6P VERTICAL P/F RECEPT SPECIAL CABLE		
C					0.XX ±0.25		projection					
					0.XXX ±0.10							
				angles	0° ±2°				product family	PwrBlade	code	213
				dr	JM GUO	03/20/07	scale		size	dwg no	sheet	4
				enrg	RYAN YUAN	03/20/07	1:1		A	51955-002		
				chr	GARY HSIEH	03/20/07						
				appd	JOSEPH HSIA	03/20/07						
sheet index	revision sheet											

1 | 2

Pro/E

3 |

cage code 22526

4