

PART NUMBER	REV	FIRST USED	APPLICATOR INSTRUCTION	EXPLODED VIEW
680300-2	G	565435-5	408-8082	SIM TO A-6139
680300-3	G	354500-1	408-8082	SIM TO A-6139

LOC	DIST	REV	DESCRIPTION	DATE	BY	APPD
A	66	G	ECR-07-003281	16FEB2007	KS	TE
		G1	ECR-07-008455	4/12/2007	KS	TE

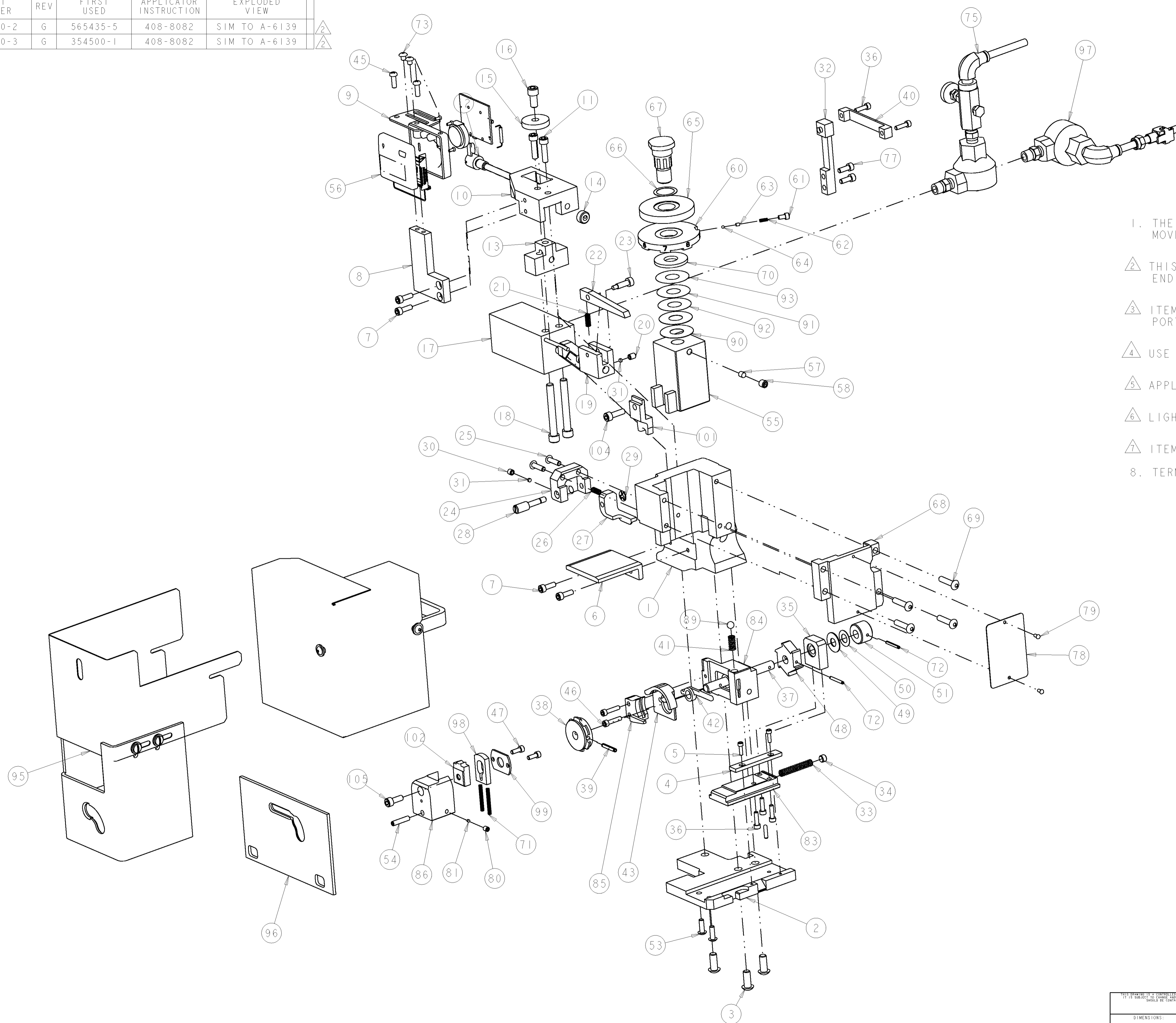

1. THE REAR HOLD-DOWN ON THE TERMINATING UNIT MUST BE MOVED TO THE FRONT OF THE BASE PLATE. FOR -3 ONLY.
2. THIS APPLICATOR TERMINATES TAPE MOUNTED CLOSED END SPLICE, P/N 2-328730-1.
3. ITEM 17 END CAP SHOULD BE ROTATED 90° WITH THE PORT UP, FOR (-3) ONLY.
4. USE IN COMBINATION TO ACHIEVE PROPER CRIMP HEIGHT.
5. APPLY A FEW DROPS OF OIL.
6. LIGHTLY GREASE (4) CORNERS OF APPLICATOR HOUSING.
7. ITEMS NOT SHOWN ON ASSEMBLY.
8. TERMINAL APPLICATOR SPEC. 114-2147.

SCALE 11:20

<small>THIS DRAWING IS UNPUBLISHED. RELEASED FOR PUBLICATION. THE INFORMATION CONTAINED HEREIN IS UNCLASSIFIED EXCEPT WHERE SHOWN OTHERWISE. IT IS THE PROPERTY OF AMP AND IS NOT TO BE REPRODUCED OR DISTRIBUTED OUTSIDE THE AMP ORGANIZATION WITHOUT THE WRITTEN PERMISSION OF AMP.</small>		DWN: STAKEM 16FEB2007 CHK: T. ELBIN 16FEB2007 APVD: T. ELBIN 16FEB2007	<b>AMP</b> Tyco Electronics Harrisburg, PA 17105-3608
DIMENSIONS: IN 		TOLERANCES UNLESS OTHERWISE SPECIFIED: 0 PLC ±.1 1 PLC ±.1 2 PLC ±.02 3 PLC ±.005 4 PLC ±.0005 ANGLES ±.0005	NAME: Quick Change Appl, Side Feed PIDG&PG 22-18, 16-14, 12-10 PRODUCT SPEC: - APPLICATION SPEC: - SIZE: CAGE CODE DRAWING NO: A100779C-680300 RESTRICTED TO: -
MATERIAL: - FINISH: -		WEIGHT: - CUSTOMER DRAWING: -	SCALE: 1:12 SHEET 1 OF 2 REV: G1

