

THIS COPY IS PROVIDED ON A RESTRICTED BASIS AND IS NOT TO BE USED IN ANY WAY DETRIMENTAL TO THE INTERESTS OF PANDUIT CORP.

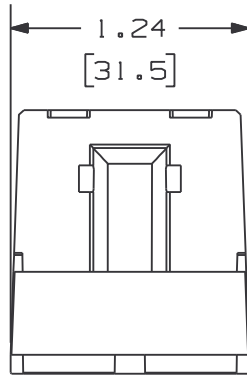

PANDUIT P/N	WEIGHT
CMDB**-X	.10 LB/10 PCS (44.2 g/10 PCS)

- NOTES:
- SEE CURRENT CATALOG FOR ADDITIONAL PART NUMBER SUFFIXES TO INDICATE COLOR AND OR PACKAGE QUANTITY.
 - SEE CATALOG FOR COMPLETE LIST OF PARTS APPLICABLE FOR USE WITH THIS PART.
 - DIMENSIONS IN PARENTHESES ARE IN METRIC.
 - PART SNAPS INTO ALL MINI-COM TWO POSITION MODULE SPACES.

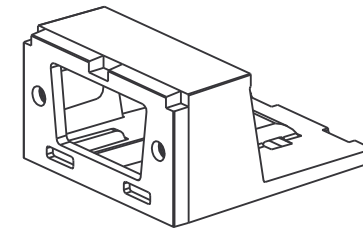
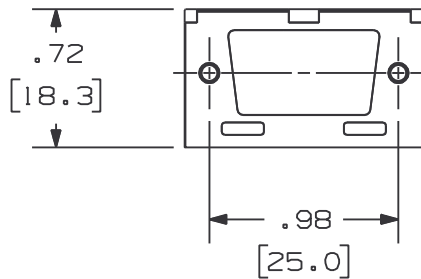
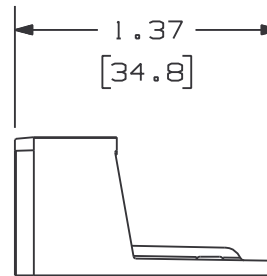

CAD FILENAME/LAYERS		M01019BD_DC_01A.PRT	
<h1>PANDUIT</h1> CORP. TINLEY PARK, ILLINOIS			
MINI-COM SVGA BLANK DUPLEX MODULE (CMDB**-X) CUSTOMER DRAWING			
UNLESS OTHERWISE SPECIFIED, DIMENSIONAL TOLERANCES ARE: (.X) ± .03 (.XX) ± .03 (.XXX) ± .010 (.XXX) ± .010 ANGLES ±		UNLESS OTHERWISE SPECIFIED, ALL DIMENSIONS ARE GIVEN IN INCHES, THIRD ANGLE PROJECTION.	
DRAWN BY	JSP	MAT'L:	SCALE
DATE	1-26-01		NONE
CHECKED BY			DRAWING NO.
			01019-02
			DWG SIZE
			A

REV	DATE	BY	CHK	DESCRIPTION	ECN	CHK	CUST	SUP
R	1-26-01	JSP		RELEASED TO PRODUCTION.	01019-02			