

50	P	66.65	52.68	61.11	11.08	14.99	1.0	5.85	2.76	11.09
	S	66.65	52.30	61.11	10.62	14.99	0.8	6.05	2.76	11.21
37	P	68.94	55.30	63.50	8.23	12.17	1.0	5.85	57.45	11.09
	S	68.94	54.71	63.50	7.77	12.17	0.8	6.05	57.45	11.21
25	P	52.65	38.84	47.04	8.23	12.17	0.8	5.85	41.02	11.07
	S	52.65	38.25	47.04	7.77	12.17	0.8	6.05	41.02	11.21
15	P	38.76	25.12	33.32	8.23	12.17	0.8	5.85	27.25	10.99
	S	38.76	24.54	33.32	7.77	12.17	0.8	6.05	27.25	11.21
09	P	30.43	16.79	24.99	8.23	12.17	0.8	5.85	19.02	10.99
	S	30.43	16.21	24.99	7.77	12.17	0.8	6.05	19.02	11.21
SHELL SIZE		+0.76 A-0	+0.25 B-0	+0.12 C-0	+0.25 D-0	+0.76 E-0	+0.22 F-0	+0.15 G-0	H±0.06	J MAX

NOTE:-INSIDE DIMENSIONS OF MALE AND OUTSIDE DIMENSIONS OF THE FEMALE CONNECTOR.

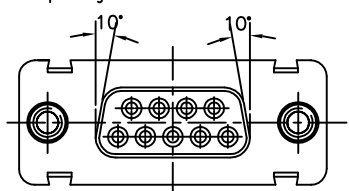
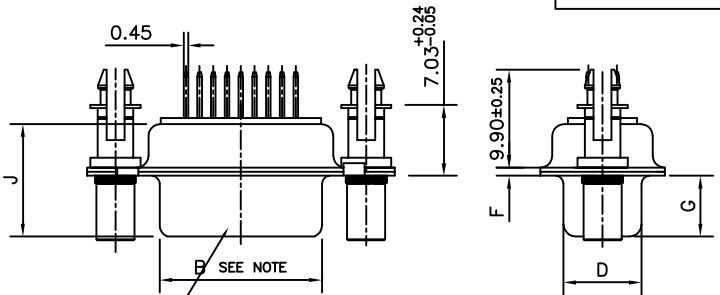

VIEW OF MATING FACE

TECHNICAL SPECIFICATIONS

- SHELLS : TIN/ZINC PLATED
- INSULATOR MATERIAL : SELF EXTINGUISHING THERMOPLASTIC- TO UL CLASS 94 V0
- THE HOUSING WILL WITHSTAND EXPOSURE TO 260-265°C IF WE USE PROTECTIVE ADHESIVE (type Kapton or Teflon) OR PROTECTIVE METALLIC DEVICE
- CONTACTS DIA ON ACTIVE AREA : Ø1 MM.
- CONTACTS MATERIAL : COPPER ALLOY
- CONTACT PLATING : GOLD OVER NICKEL(ACTIVE ZONE)
- FOR LEAD FREE PLATING : TINLEAD OVER NICKEL(TERMINATION ZONE)
- OPERATING TEMPERATURE : -55°C +125°C
- OPERATING CURRENT : 5 A PER CONTACT
- INSULATION RESISTANCE : >5000 MΩ
- MAXIMUM VOLTAGE : 1000 V.r.m.s
- MECHANICAL ENDURANCE : 100 MATINGS .
- DAMP HEAT : 21 DAYS.

ORDERING INFORMATION

DAV 15 P 3 65 G T X LF

- SERIES : DAV
- SHELL SIZE : 15
- E.A.B.C&D : P 3 65
- V - FEMALE SCREW UNC 4 40 2B (F SCR LCK WITH IN BUILT HARPOON)
- NO.OF CONTACTS : G T X
- CONTACTS : LF
- P - MALE
- S - SOCKET
- TERMINATION TYPE : 3 - STRAIGHT SPILL
- LEAD FREE
- DIMPLES
- X-ON MALE CONNECTOR ONLY
- SHELL PLATING
- T - TIN/ZINC Cr 3 PLATED SHELL
- G - HARPOONS WITH IN BUILT F.SCREW LOCK
- CONTACT PLATING
- 64 - Au FLASH
- 65 - 0.75μAu
- 67 - 0.4μAu

"This LF product meets European Union Directives and other country regulations as described in GS-22-008"  
 The housing will withstand exposure to 260°C peak temperature for 3.5 seconds in a wave solder application with a 1.6mm minimum thick circuit board.  
 Pckaging as per GS-14-920

mat'l. code		surface		tolerance		projection		product family	
SEE NOTE 4		ISO 1302		ISO 406 ISO 1101				D-SUB STRAIGHT SPILL CONNECTOR (WITH BOARD LOCK,HEX.FEM.SCREW LOCK).	
ltr	ecn no	dr	date	tolerances unless otherwise specified		MM		title	
D	106-074	GVJ	2006/06/08	angles	linear			Dwg no sheet 1 of 1 size	
		dr	Mini K Vandanath	1999/03/20		FCJ		C-D-SUB-0142 A3	
		enr	George V Joseph	1999/03/20				type Product Customer Drawing	
		chr	George V Joseph	2006/06/23					
		appd	K-V SIVADAS	2006/06/23					
sheet index	revision	D							
	sheet	1							



Copyright FCI