

PRODUCT NUMBER	PITCH
Klxx30x200J0G	3.81 mm

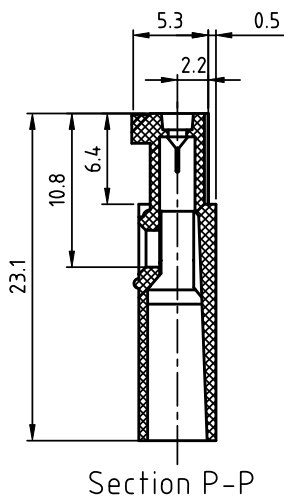
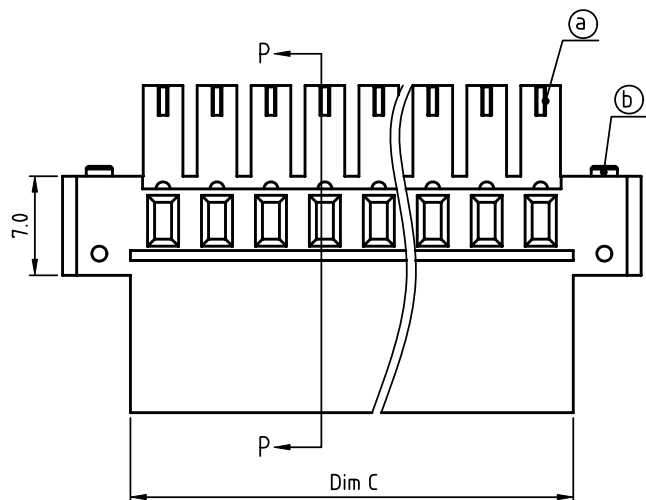
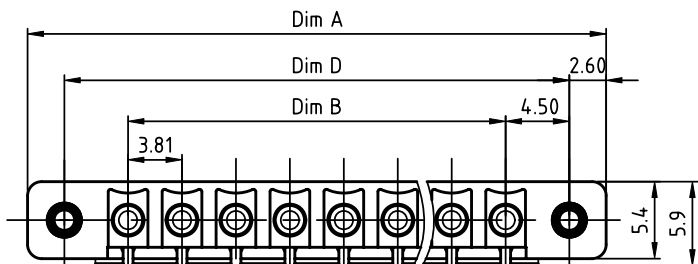

- Material:
- Item (a) Terminal housing: Thermoplastic (UL94 V-0)
 - Item (b) With flange screw: Steel Zinc plated, M2.5"/+/-"
- Electrical cULus
- Voltage rating: 160V
 - Current rating: 8A
 - Wire range: 1.0~1.2mm²
 - Withstanding Voltage: 1.32KV
 - Corresponding female crimp contacts: A0 3.81 series

N=number of poles

Dim A=(N-1)x3.81+14.20
Dim B=(N-1)x3.81
Dim C=(N-1)x3.81+4.60
Dim D=(N-1)x3.81+9.0

Poles	2P~6P	7P~12P	13P~18P	19P~24P
Dim A	±0.20	±0.25	±0.30	±0.35
Dim B	±0.15	±0.20	±0.25	±0.30
Dim C	±0.20	±0.25	±0.30	±0.35
Dim D	±0.20	±0.25	±0.30	±0.35

PART NO.: Kl xx 30 x 2 00J0 G

Solid block	0	Black (RAL9005)	RoHS compliant (lead<4%) In copper Alloy
No. of poles	2	Red (RAL3001/D)	
02	2 poles	3 Orange(RAL2011/P)	
03	3 poles	4 Yellow(RAL1018/A)	
...	...	5 Green(RAL6018/T)	
24	24 poles	6 Blue (RAL5015/A)	
		8 Grey(RAL7035/D)	
		9 White(RAL1102)	
		C Green(RAL6018/U)	

mat'l. code		surface ASME Y14.5 ✓	tolerance ASME Y14.5	projection 	product family TERMINAL BLOCK
ltr	ecn no	dr	date	tolerances unless otherwise specified	title TERMINAL BLOCK
				angles 	
				X.±0.5	← MM →
				X.X±0.3	scale
				X.XX±0.1	PLUGGABLE PLUG, WITH FLANGE, CRIMP CONNECTION
dr	EVIN ZHONG	050414			dwg no
enr	EVIN ZHONG	050414			sheet 1 of 1
chr	HANKE FENG	050414			size
appd	SHI JUN	050414			Klxx30x200J0G
					A4
					type
					CUSTOMER Drawing
sheet index	revision	A			
	sheet	1			